

QUANTUM

IR7F / IR8F

IRON

SPECIFICATIONS :

X Hvy FW / Hvy SW

Line Capacity :

260 yds / 20 - IR7F

330 yds / 20 lb - IR8F

4.8:1 Gear Ratio

Weight :

18.6 oz. - IR7F

21.1 oz. - IR8F

4 Stainless Steel Ball Bearings

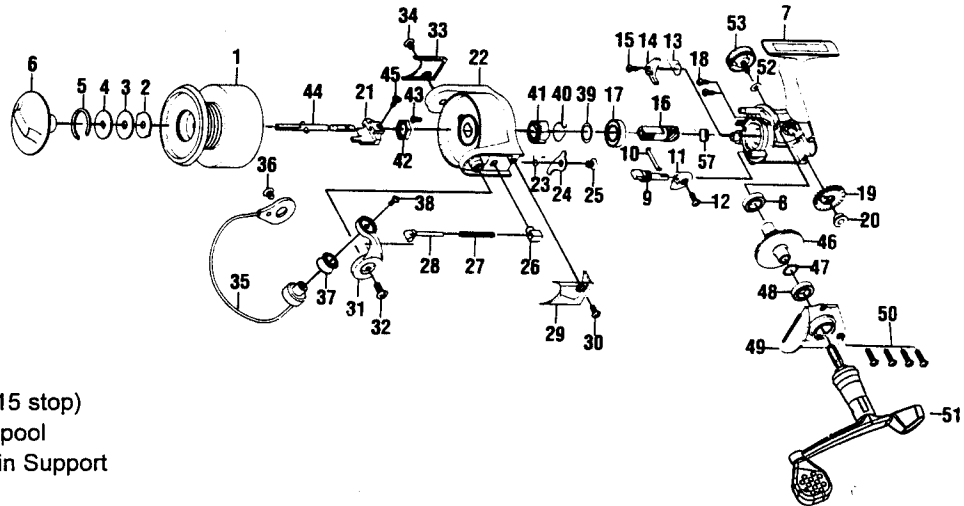

FEATURES :

Front Drag

Balanced Rotor

Balanced Handle

Twist Reducer Line Roller

POSI-Loc Selective Anti-Reverse (15 stop)

Aluminum Long Stroke Max-Cast Spool

Aluminum Side Cover for Drive Train Support

Brass Pinion and Drive Gear

Key No.	Part No. IF7F	Part No. IR8F	DESCRIPTION	Price	Key No.	Part No. IR7F	Part No. IR8F	DESCRIPTION	Price
1	BH321-61	BH321-71	Spool Assembly	11.20	28	BH031-61	BH031-71	Spring Shaft	0.96
2	BH081-21	←	Spool Washer "A"	0.59	29	BH046-61	BH046-71	Arm Lever Cover	1.80
3	BH033-21	←	Spool Washer "B"	0.64	30	BH085-14	←	Cover Screw	0.62
4	BH080-31	←	Spool Washer "D"	0.96	31	BH007-61	←	Arm Lever	1.60
5	BH038-21	←	Drag Retainer	1.01	32	BH044-14	←	Arm Lever Screw	0.62
6	BH332-45	←	Drag Knob Assembly	3.35	33	BH024-61	←	Bail Holder Cover	1.75
7	BH001-61	←	Body	7.00	34	BH085-14	←	Cover Screw	0.62
8	BH027-61	←	Ball Bearing	7.96	35	BH347-61	BH347-71	Bail Assembly	3.19
9	BH090-11	←	Stopper Cam	1.60	36	BH044-14	←	Bail Holder Screw	0.62
10	BH089-11	←	Stopper Cam Spring	0.96	37	BH004-14	←	Line Roller Ball Bearing	4.14
11	BH059-14	←	Stopper Lever	1.08	38	BH108-14	←	Bail Screw	0.62
12	BH135-13	←	Stopper Lever Screw	0.47	39	BH110-61	←	Bearing Washer	1.28
13	BH061-61	←	Stopper Spring	1.44	40	BH086-61	←	Silent Spring	1.65
14	BH063-61	←	Stopper	1.28	41	BH060-61	←	Ratchet Gear	1.28
15	BH077-61	←	Stopper Screw	0.52	42	BH006-61	←	Rotor Nut	1.28
16	BH011-61	←	Pinion Gear	3.34	43	BH094-11	←	Rotor Nut Lock Screw	0.64
17	BH028-61	←	Ball Bearing	7.96	44	BH315-61	BH315-71	Main Shaft Assembly	3.08
18	BH041-61	←	Bearing Screw	0.54	45	BH100-61	←	Main Shaft Screw	0.54
19	BH053-61	←	O/S Gear	1.65	46	BH012-61	←	Driver Gear	10.00
20	BH158-61	←	O/S Gear Bushing	0.93	47	BH026-61	←	Adjust Washer	1.06
21	BH025-61	←	O/S Slider	2.17	48	BH027-61	BH027-61	Ball Bearing	7.96
22	BH009-61	BH009-71	Rotor	6.50	49	BH023-61	←	Body Cover	2.60
23	BH049-61	BH049-71	Kick Lever Spring	0.96	50	BH057-14	←	Body Cover Screw	0.62
24	BH019-61	BH019-71	Kick Lever	1.65	51	BH318-61	←	Handle Assembly	7.00
25	BH136-61	←	Kick Lever Screw	0.64	52	BH105-11	←	Handle Cap Washer	0.47
26	BH020-11	←	Spring Holder	0.96	53	BH073-33	←	Handle Screw Cap	2.44
27	BH022-61	BH022-71	Arm Lever Spring	1.06	57	BH141-61	←	Pinion Bushing	0.95

MODEL	EFFECTIVE DATE OF	
INTRODUCED : 1998	PARTS LIST/DIAGRAM: July '98	DISCONTINUED : N/A

Prices subject to change without notice. Prices do not include postage and handling.

PLEASE ORDER BY PART NUMBER

Zebco, P.O. Box 270, Tulsa, Ok. 74101; 918-831-6965 Phone or 800-FIXREEL (349-7335) FAX

